

**Legend**

**PLANIMETRY**

- Flightline / Photo Center
- Creek
- Creek (indefinite)
- Reservoir
- Wetlands
- Domestic Water Intake
- Highway
- Gravel Road
- W. Built Road
- W. Proposed Road
- Trail
- Bridge
- Transmission Line
- Fence
- Flume/Ditch
- Pipeline

**TOPOGRAPHY**

- Index Contour
- Intermediate Contour
- Indefinite Contour
- Spot Elevation

**FOREST COVER**

- Stand Boundary
- Pothook
- Scrub
- Logged
- Planted
- Burned

**BOUNDARIES**

- Woodlot
- Proposed Block
- Riparian Reserve Zone
- Riparian Management Zone
- Wildlife Tree Patch
- Timber Leave Area

**STREAM CLASSIFICATION**

- Class S1 - S4
- Class S5 - S6

**FOREST COVER LABEL**

123ES - POLYGON NUMBER/ESA CODES

CF(SH) SPECIES COMPOSITION

2 - AGE CLASS CODE

123ES - HEIGHT CLASS CODE

CF(SH) 1 - STOCKING CLASS CODE

2101-20 - CROWN CLOSURE

0 - SITE INDEX

**SPECIES SYMBOLS**

F - Douglas Fir	Pl - Lodgepole Pine
C - Western Red Cedar	Y - Yellow Pine
H - Hemlock	L - Larch
B - Balsam	Ct - Cottonwood
S - Spruce	D - Red Alder
Sb - Black Spruce	Mb - Broadleaf Maple
Cy - Yellow Cedar	Bl - Birch
Pw - Western White Pine	As - Aspen
Pa - Whitebark Pine	

**AGE CLASS CODES**

CODE - LIMITS (years)	CODE - LIMITS (metres)
1 1 - 20	1 0 - 10.4
2 21 - 40	2 10.5 - 19.4
3 41 - 60	3 19.5 - 28.4
4 61 - 80	4 28.5 - 37.4
5 81 - 100	5 37.5 - 46.4
6 101 - 120	6 46.5 - 55.4
7 121 - 140	7 55.5 - 64.4
8 141 - 250	8 64.5 - 73.5
9 251+	

**CROWN CLOSURE CLASS CODES**

CODE - LIMITS (percentage)	CODE - LIMITS (percentage)
0 0 - 5	6 56 - 65
1 6 - 15	7 66 - 75
2 16 - 25	8 76 - 85
3 26 - 35	9 86 - 95
4 36 - 45	10 96 - 100
5 46 - 55	

**STOCKING CLASS CODES**

CODE - APPLIES TO	LIMITS (no. of trees)
0 all mature	n/a
1 all mature	greater than 70m, 27.5 cm d.b.h.
2 all mature	less than 70m, 27.5 cm d.b.h.
3 mature with leading	less than 31m, 17.5 cm d.b.h.
4 (species Pl)	less than 31m, 17.5 cm d.b.h. and less than 50% of stems 7.5 cm d.b.h. or greater than 12.5 cm d.b.h.

**SILVICULTURE SYSTEM**

- CLRCT - Clearcut
- CCRES - Clearcut with reserves
- SEEDT - Seed tree
- SHELT - Shelterwood
- PCHCT - Patch cut
- IMCUT - Intermediate cut

**HARVESTING METHOD**

- DC - Overhead cable
- A - Aerial
- GB - Ground base (conventional)
- H - Horse

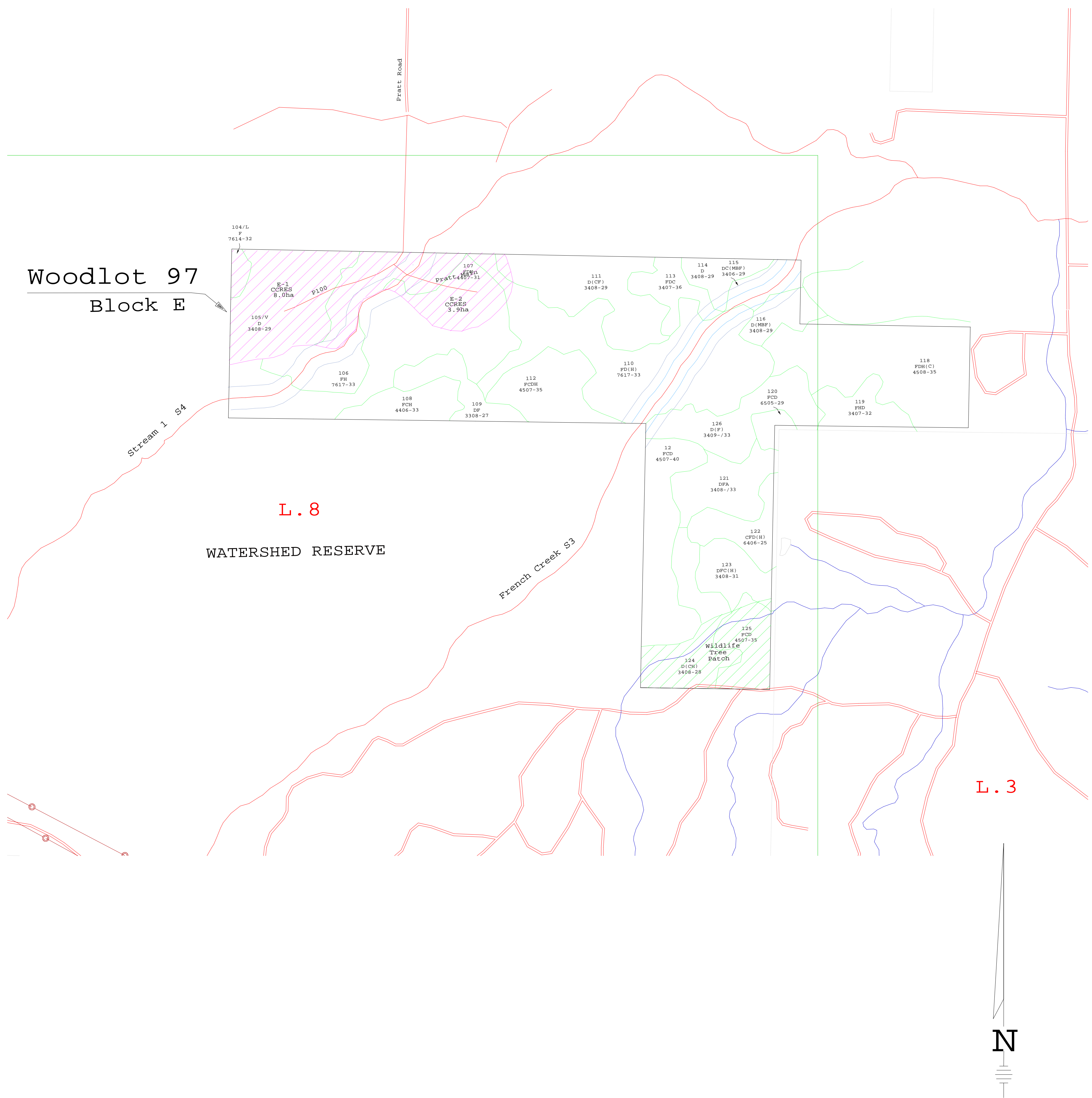

Woodlot 97  
Block E

L.8

WATERSHED RESERVE

French Creek S3

L.3

